

Hinges with curved edges / SS finish

15 Hardwood lipping

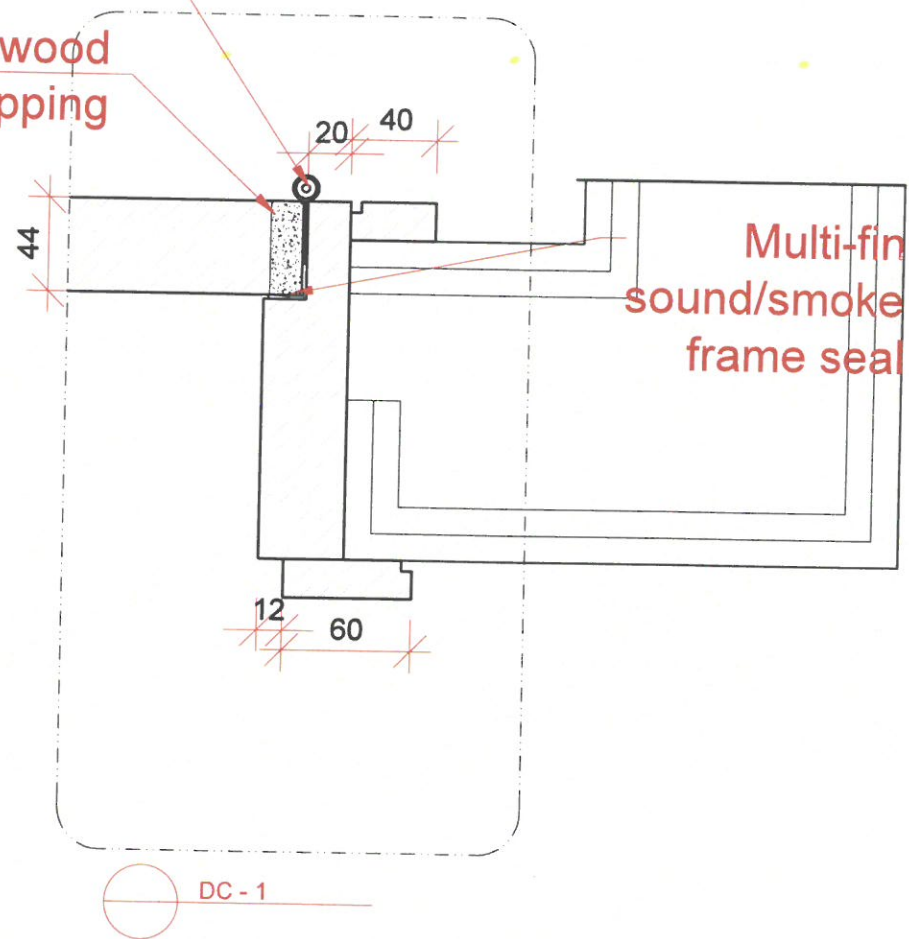

D36	Ancillary Building doors	
panel Size	900mm W x 2100mm H x 44mm thk	
Finish	Painted to match FOH Finish PNT-302	
Door leaf type	Single door, single swing Flush door	
Ironmongery & Accessories	Solenoid lock	Stainless steel
	Contactless smartcard reader	Stainless steel
	Magnetic door contact	Stainless steel
	Door closer - Non hold open	Stainless steel
	Hinges Type 2: Hinges with curved edges	Stainless steel
	Half moon door stop & Kick plate 450mmH by width of door	Stainless steel
	Kick plate 450mmH by width of door	Stainless steel
Location	BOH toilet doors	
Total QTY	3	
Fire Rating	NA	
Acoustic	NA	
Remarks		

