

Hinges with curved edges / SS finish

15 Hardwood lipping

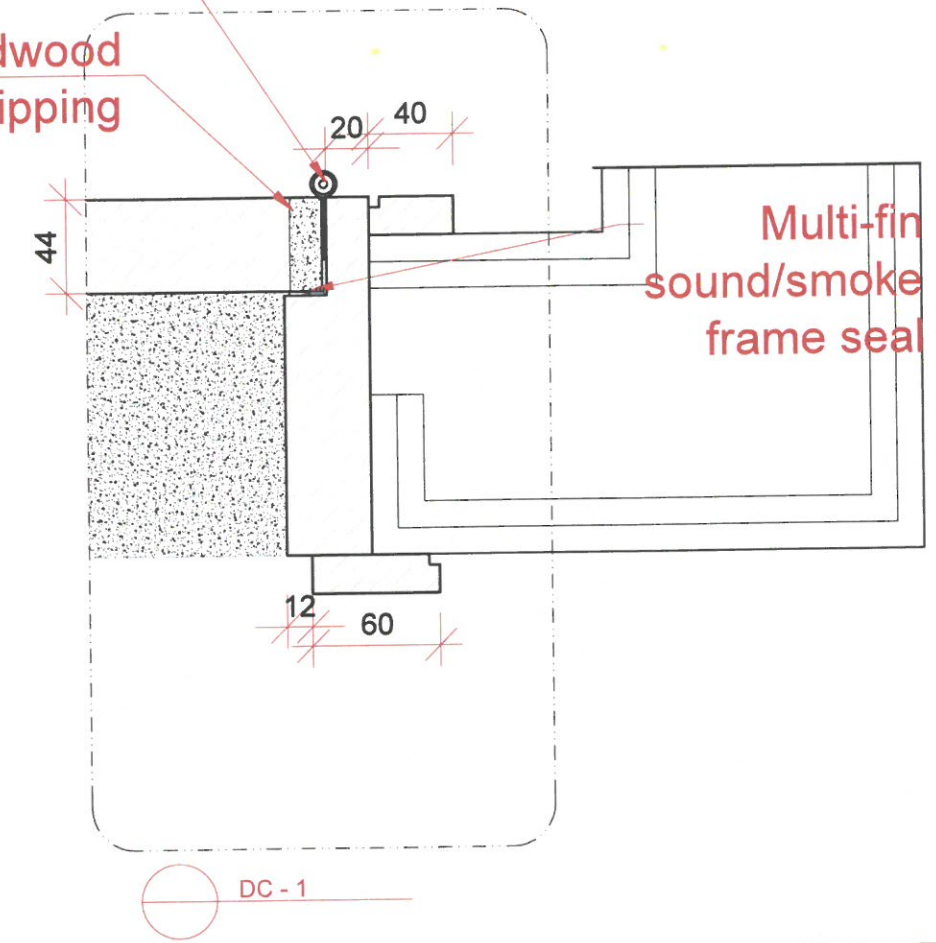

Multi-fin sound/smoke frame seal

D13b-1	MEZZ Spa changing room entrance door	
panel Size	900mm W x 2300mm H x 44mm thk	
Finish	Painted to match PNT-304 (outside) & PNT-302 (inside)	
Door leaf type	Single door, single swing Flush door	
Ironmongery & Accessories	Lock: Cylinder Deadlock	Black Finish
	Knob cylinder grand masterkeyed	Black Finish
	Cylinder escutcheon	Black Finish
	Door closer - Concealed Door closer EN 2-4 Non hold open	Black Finish
	Hinges Type 2: Hinges with curved edges	Black Finish
	Pull handle	Black Finish
	Doorstop Type 2	Black Finish
	Location	MEZZ Spa changing room entrance
Total QTY	2	
Fire Rating	NA	
Acoustic	NA	
Remarks	NOTE : - Images and physical samples of all ironmongeries have been submitted for approval and have been approved. - General arrangement for door handling (LHS / RHS) will be considered for production	

